

4

3

2

1

Top View

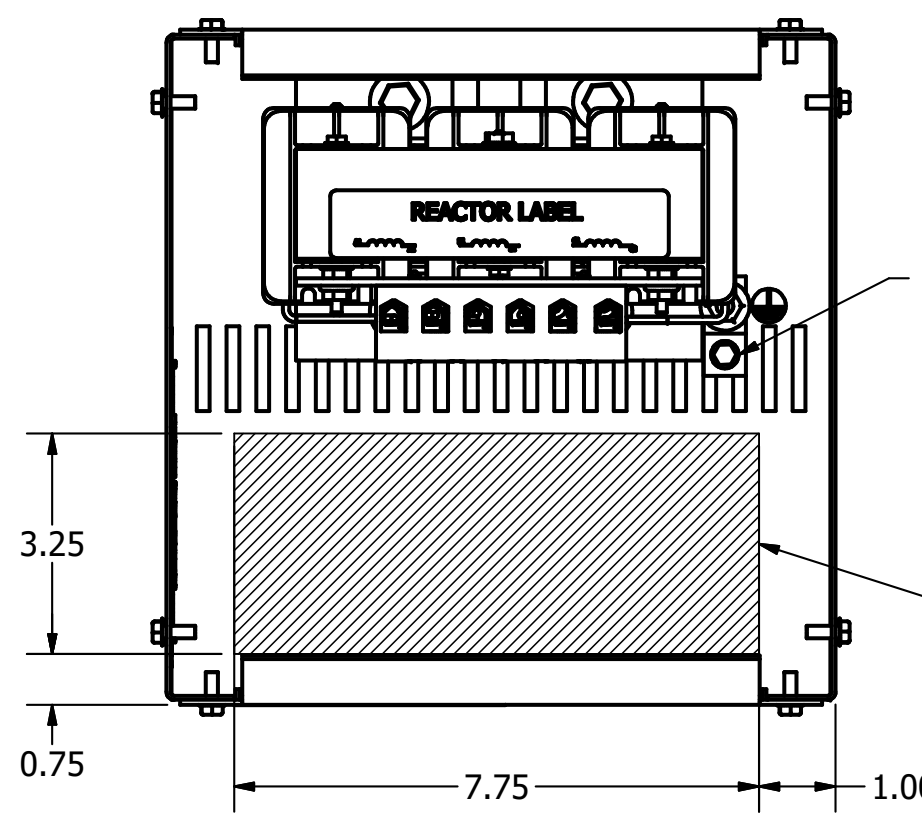
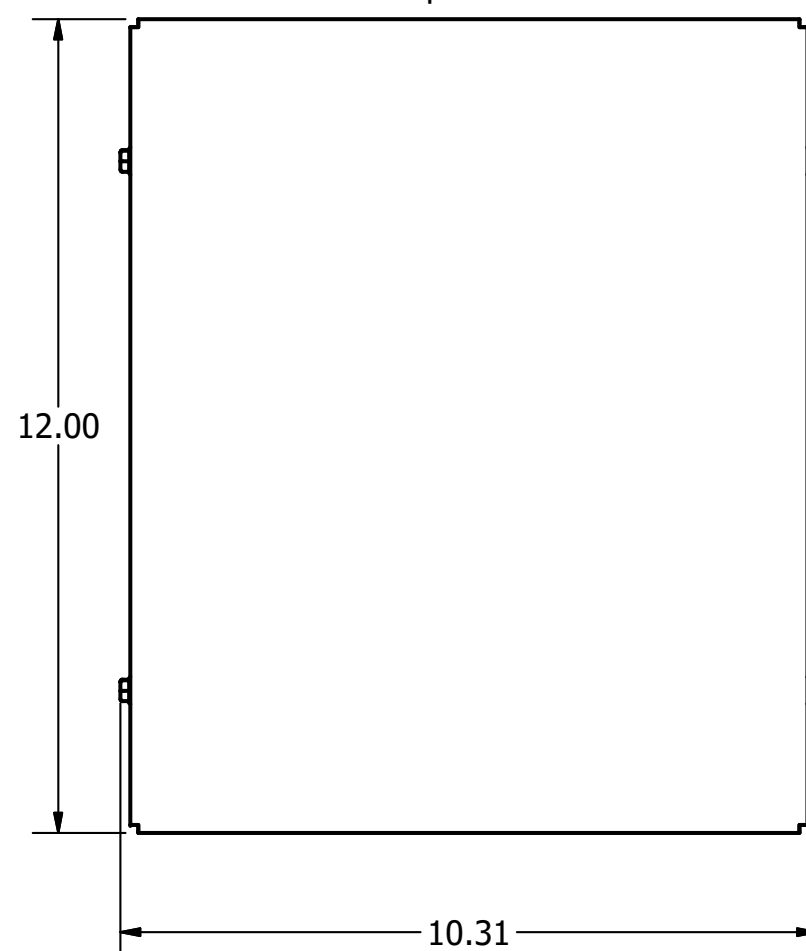

Ground Lug.  
See IOM Manual, Part# 30895  
Table S2/0, Wire Size And Torque.

Suggested  
Customer Wire Entrance  
Bottom Of Enclosure.  
See Note: 5  
(Non Removeable Panel)

480 Rated Voltage, 600 Max Voltage, High Z, Impedance.						
Part Number	Horsepower (HP)	Motor Amps (A)	Maximum Amps (A)	Inductance (uH)	Weight (LBS)	Losses (W)
KDRE2HE3R	30	40	45	850	31	141

575 Rated Voltage, 600 Max Voltage, High Z, Impedance.						
Part Number	Horsepower (HP)	Motor Amps (A)	Maximum Amps (A)	Inductance (uH)	Weight (LBS)	Losses (W)
KDRE42HE3R	30	32	32	1430	31	140

TCI Logo Front View With Front Cover

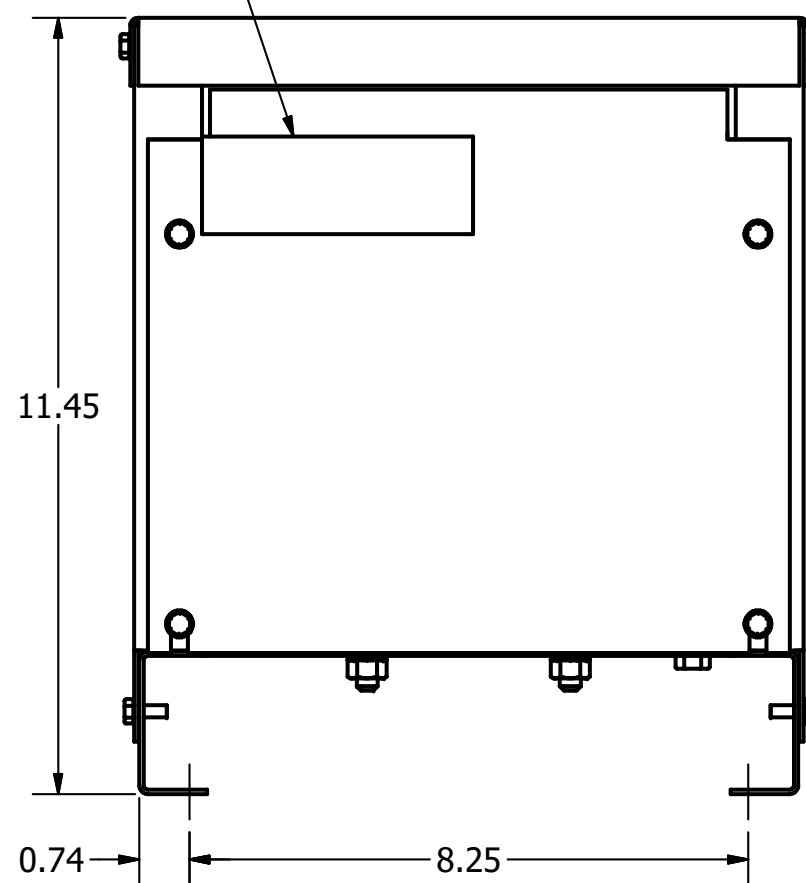

Front View Without Front Cover

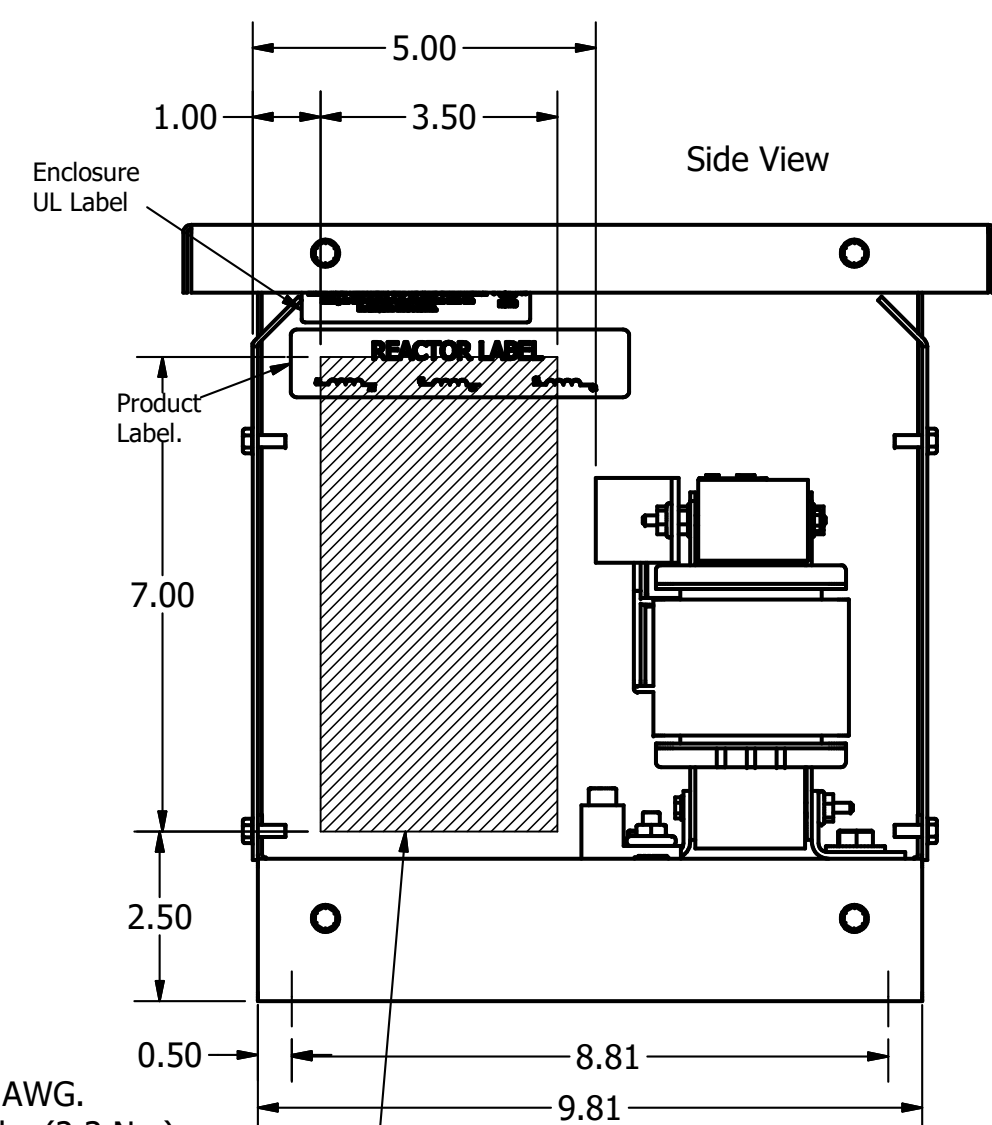
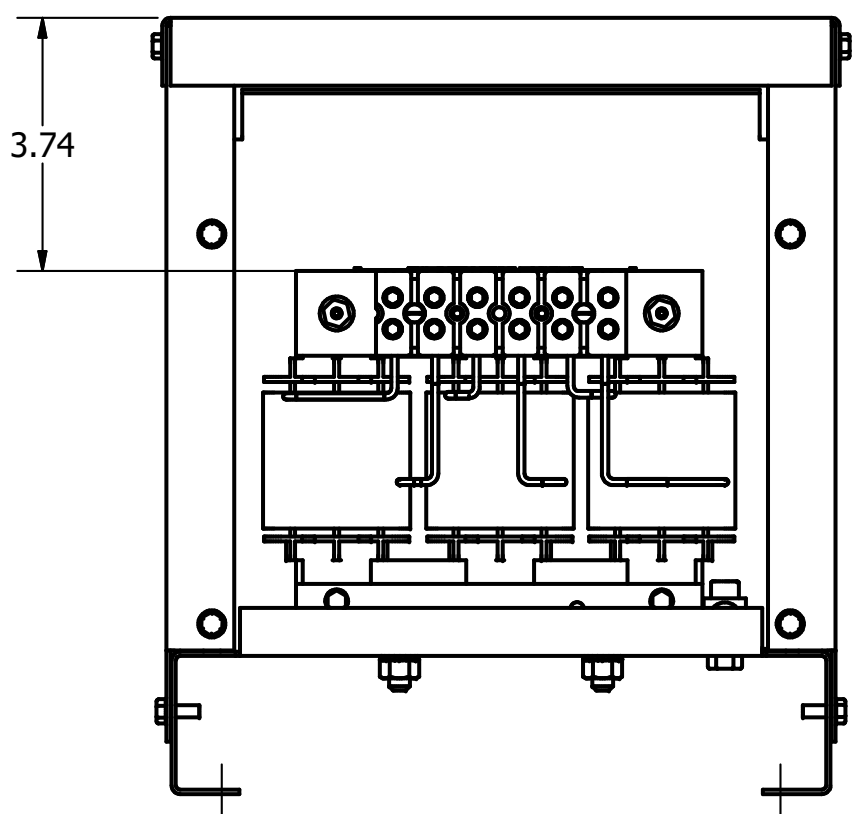

Wire Range: 4 - 18 AWG.  
Torque : 20 In-lbs (2.3 Nm)

Suggested  
Customer Entrance  
Either Side Of Enclosure.  
See Note: 5  
(Non Removeable Panel)

Bottom View

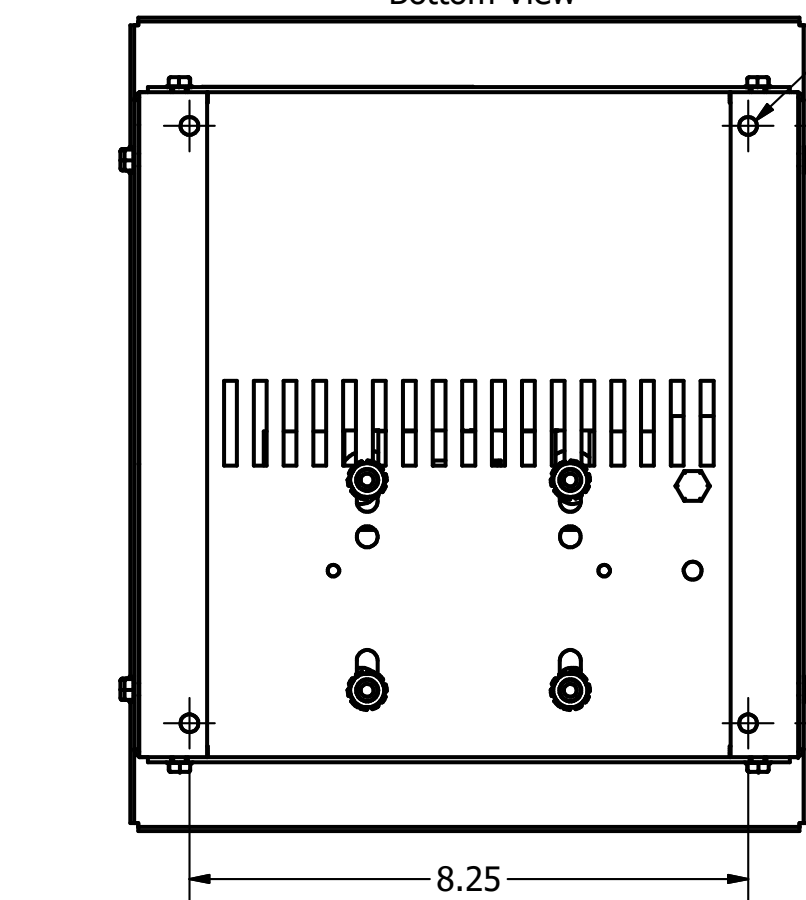

0.27 Dia Holes  
4 Places, (Bottom of Enclosure)

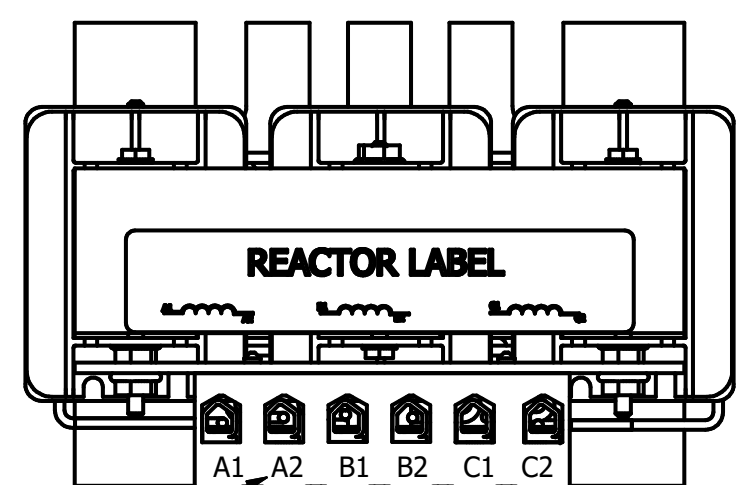
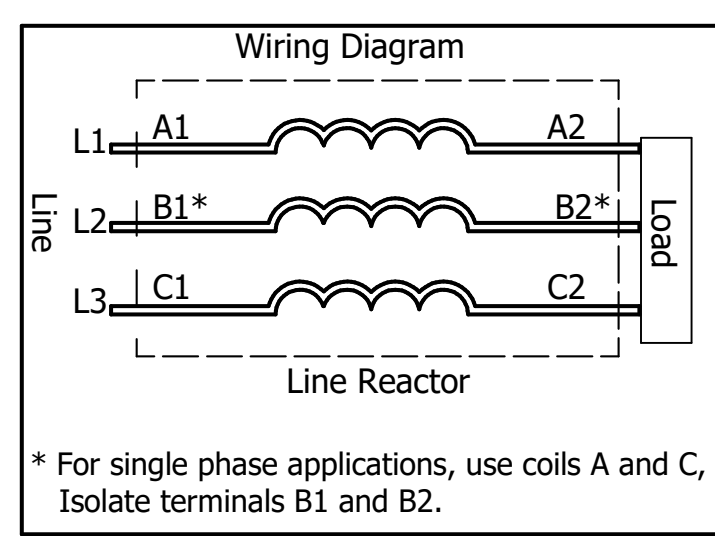

Markings On  
Terminal Block For  
Reference Only.

**TCI** (800) 824-8282 [transcoil.com](http://transcoil.com)

TCI, LLC  
Greenwood, WI, USA  
[transcoil.com](http://transcoil.com)  
800-824-8282

KDRUL Drive Reactor  
KDR- Motor Amps —  
3PH, 50/60Hz, —V Rated, 600V Max, —A Max, Ref#S  
48C Amb Max, 135C Rise  
Manual 30895

UL LISTED CE

- Notes:
1. UL file number: cULus Listed File E116124.
  2. KDR Drive Reactors Comply With The Thermal and Altitude Standards Set Forth by NEMA ST20-1992.
  3. KDR IOM Manual Part Number 30895
  4. Material(s) Shall be RoHS Compliant
  5. Customer Is Responsible For Installation To Meet All National And Local Electrical Codes.

TCI, LLC CLAIMS PROPRIETARY RIGHTS IN THE MATERIAL HEREIN DISCLOSED. IT IS SUPPLIED WITHOUT PREJUDICE TO ANY PATENT RIGHTS OF TCI AND MAY NOT BE REPRODUCED OR USED TO MANUFACTURE ANYTHING SHOWN THEREIN WITHOUT WRITTEN PERMISSION FROM TCI.

TOLERANCES (EXCEPT AS NOTED)			
DECIMAL			
	XX ± .25		
	.XXX ± .10		
FRACTIONAL			
	± 1/16		
ANGULAR			
	± 1°		

**TCI** W132 N10611 Grant Drive  
Germantown, WI 53022

KDR E Frame, Terminal Block, Enclosed  
Type 3R, Reactor Drawing

DRN BY: DSW DATE: 4/23/18 107551DG  
SCALE: 1/3 APRVD: SIZE C SHT. 1 OF 2

4

3

2

1